

Planetary Gearhead GP 42 C $\varnothing 42$ mm, 3 - 15 Nm

Ceramic Version

maxon gear

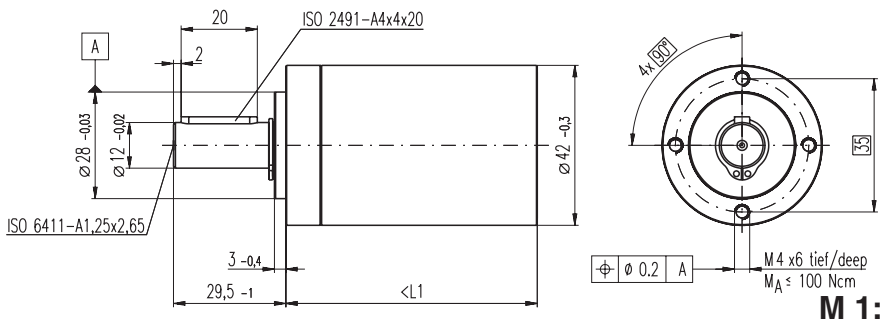

Technical Data

Planetary Gearhead	straight teeth
Output shaft	stainless steel
Bearing at output	preloaded ball bearings
Radial play, 12 mm from flange	max. 0.06 mm
Axial play at axial load	< 5 N 0 mm > 5 N max. 0.3 mm
Max. permissible axial load	150 N
Max. permissible force for press fits	300 N
Sense of rotation, drive to output	=
Recommended input speed	< 8000 rpm
Recommended temperature range	-20 ... +100°C
Extended area as option	-35 ... +100°C
Number of stages	1 2 3 4
Max. radial load, 12 mm from flange	120 N 150 N 150 N 150 N

- Stock program
- Standard program
- Special program (on request)

Order Number

203113	203115	203119	203120	203124	203129	203128	203133	203137	203141
--------	--------	--------	--------	--------	--------	--------	--------	--------	--------

Gearhead Data

1 Reduction	3.5 : 1	12 : 1	26 : 1	43 : 1	81 : 1	156 : 1	150 : 1	285 : 1	441 : 1	756 : 1
2 Reduction absolute	7/2	49/4	26	343/8	2197/27	156	2401/16	15379/54	441	756
3 Mass inertia	gcm ²	14	15	9.1	15	9.4	9.1	15	15	14
4 Max. motor shaft diameter	mm	10	10	8	10	8	10	10	10	10
Order Number	203114	203116		203121	203125		203130	203134	203138	203142
1 Reduction	4.3 : 1	15 : 1		53 : 1	91 : 1		186 : 1	319 : 1	488 : 1	936 : 1
2 Reduction absolute	13/3	91/6		637/12	91		4459/24	637/2	4394/9	936
3 Mass inertia	gcm ²	9.1	15	15	15		15	15	9.4	9.1
4 Max. motor shaft diameter	mm	8	10	10	10		10	10	8	8
Order Number		203117		203122	203126		203131	203135	203139	
1 Reduction		19 : 1		66 : 1	113 : 1		230 : 1	353 : 1	546 : 1	
2 Reduction absolute		169/9		1183/18	338/3		8281/36	28561/81	546	
3 Mass inertia	gcm ²	9.4		15	9.4		15	9.4	14	
4 Max. motor shaft diameter	mm	8		10	8		10	8	10	
Order Number		203118		203123	203127		203132	203136	203140	
1 Reduction		21 : 1		74 : 1	126 : 1		257 : 1	394 : 1	676 : 1	
2 Reduction absolute		21		147/2	126		1029/4	1183/3	676	
3 Mass inertia	gcm ²	14		15	14		15	15	9.1	
4 Max. motor shaft diameter	mm	10		10	10		10	10	8	
5 Number of stages		1	2	2	3	3	3	4	4	4
6 Max. continuous torque	Nm	3.0	7.5	7.5	15.0	15.0	15.0	15.0	15.0	15.0
7 Intermittently permissible torque at gear output	Nm	4.5	11.3	11.3	22.5	22.5	22.5	22.5	22.5	22.5
8 Max. efficiency	%	90	81	81	72	72	72	64	64	64
9 Weight	g	260	360	360	460	460	460	560	560	560
10 Average backlash no load	°	0.3	0.4	0.4	0.5	0.5	0.5	0.5	0.5	0.5
11 Gearhead length L1*	mm	40.9	55.4	55.4	69.9	69.9	69.9	84.4	84.4	84.4

*for EC 45 flat is L1 - 3.5 mm



Combination

+ Motor	Page	+ Tacho	Page	+ Brake	Page	Overall length [mm]	= Motor length + gearhead length + (tacho / brake) + assembly parts									
RE 35, 90 W	82					111.9	126.4	126.4	140.9	140.9	155.4	155.4	155.4	155.4		
RE 35, 90 W	82	MR	259			123.3	137.8	137.8	152.3	152.3	166.8	166.8	166.8	166.8		
RE 35, 90 W	82	HED_ 5540	262/264			132.9	147.4	147.4	161.9	161.9	176.4	176.4	176.4	176.4		
RE 35, 90 W	82	DCT 22	271			130.0	144.5	144.5	159.0	159.0	173.5	173.5	173.5	173.5		
RE 35, 90 W	82			AB 28	308	148.0	162.5	162.5	177.0	177.0	191.5	191.5	191.5	191.5		
RE 36, 70 W	83					112.2	126.7	126.7	141.2	141.2	155.7	155.7	155.7	155.7		
RE 36, 70 W	83	MR	259			123.6	138.1	138.1	152.6	152.6	167.1	167.1	167.1	167.1		
RE 36, 70 W	83	HED_ 5540	262/264			133.2	147.7	147.7	162.2	162.2	176.7	176.7	176.7	176.7		
RE 36, 70 W	83	DCT 22	271			130.3	144.8	144.8	159.3	159.3	173.8	173.8	173.8	173.8		
RE 40, 150 W	84					112.0	126.5	126.5	141.0	141.0	155.5	155.5	155.5	155.5		
RE 40, 150 W	84	MR	259			123.4	137.9	137.9	152.4	152.4	166.9	166.9	166.9	166.9		
RE 40, 150 W	84	HED_ 5540	262/264			132.7	147.2	147.2	161.7	161.7	176.2	176.2	176.2	176.2		
RE 40, 150 W	84	HEDL 9140	267			166.1	180.6	180.6	195.1	195.1	209.6	209.6	209.6	209.6		
RE 40, 150 W	84			AB 28	308	148.1	162.6	162.6	177.1	177.1	191.6	191.6	191.6	191.6		
RE 40, 150 W	84			AB 28	309	156.1	170.6	170.6	185.1	185.1	199.6	199.6	199.6	199.6		
RE 40, 150 W	84	HED_ 5540	262/264	AB 28	308	165.2	179.7	179.7	194.2	194.2	208.7	208.7	208.7	208.7		
RE 40, 150 W	84	HEDL 9140	267	AB 28	309	176.6	191.1	191.1	205.6	205.6	220.1	220.1	220.1	220.1		
EC 40, 120 W	165					111.0	125.5	125.5	140.0	140.0	154.5	154.5	154.5	154.5		
EC 40, 120 W	165	HED_ 5540	263/265			129.4	143.9	143.9	158.4	158.4	172.9	172.9	172.9	172.9		
EC 40, 120 W	165	Res 26	272			137.6	152.1	152.1	166.6	166.6	181.1	181.1	181.1	181.1		
EC 40, 120 W	165			AB 28	308	141.8	156.3	156.3	170.8	170.8	185.3	185.3	185.3	185.3		
EC 45, 150 W	166					152.2	166.7	166.7	181.2	181.2	195.7	195.7	195.7	195.7		
EC 45, 150 W	166	HEDL 9140	267			167.8	182.3	182.3	196.8	196.8	211.3	211.3	211.3	211.3		
EC 45, 150 W	166	Res 26	272			152.2	166.7	166.7	181.2	181.2	195.7	195.7	195.7	195.7		
EC 45, 150 W	166			AB 28	309	159.6	174.1	174.1	188.6	188.6	203.1	203.1	203.1	203.1		
EC 45, 150 W	166	HEDL 9140	267	AB 28	309	176.6	191.1	191.1	205.6	205.6	220.1	220.1	220.1	220.1		
EC 45 flat, 30 W	202					53.9	68.4	68.4	82.9	82.9	97.4	97.4	97.4	97.4		
EC 45 flat, 50 W	203					58.8	73.3	73.3	87.8	87.8	102.3	102.3	102.3	102.3		
EC 45 fl, IE, IP 00	204					72.8	87.3	87.3	101.8	101.8	116.3	116.3	116.3	116.3		
EC 45 fl, IE, IP 40	204					75.0	89.5	89.5	104.0	104.0	118.5	118.5	118.5	118.5		
EC 45 fl, IE, IP 00	205					77.8	92.3	92.3	106.8	106.8	121.3	121.3	121.3	121.3		
EC 45 fl, IE, IP 40	205					80.0	94.5	94.5	109.0	109.0	123.5	123.5	123.5	123.5		