

Planetary Gearhead GP 16 A $\varnothing 16$ mm, 0.1 - 0.3 Nm

Metal Version, Sleeve Bearing

maxon gear

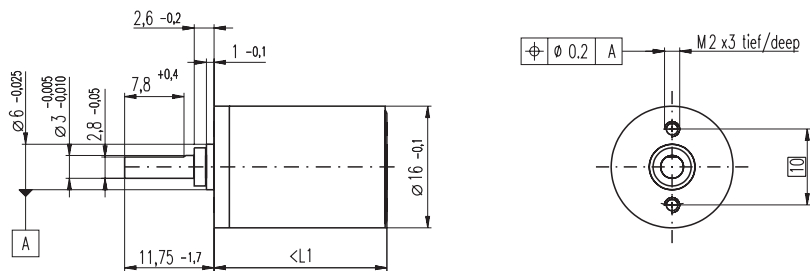

M 1:1

Technical Data

Planetary Gearhead	straight teeth
Output shaft	stainless steel, hardened
Bearing at output	sleeve bearing
Radial play, 6 mm from flange	max. 0.06 mm
Axial play	0.02 - 0.10 mm
Max. permissible axial load	8 N
Max. permissible force for press fits	100 N
Sense of rotation, drive to output	=
Recommended input speed	< 8000 rpm
Recommended temperature range	-15 ... +100°C
Extended area as option	-35 ... +100°C
Number of stages	1 2 3 4 5
Max. radial load, 6 mm from flange	8 N 12 N 16 N 20 N 20 N

- Stock program
- Standard program
- Special program (on request)

Order Number

110321	110322	110323	118186	110324	134782	110325	134785
--------	--------	--------	--------	--------	--------	--------	--------

Gearhead Data

1 Reduction	4.4 : 1	19 : 1	84 : 1	157 : 1	370 : 1	690 : 1	1621 : 1	3027 : 1
2 Reduction absolute	57/13	3249/169	185193/2197	19683/125	10556001/28561	1121931/1625	601692057/371293	63950067/21125
3 Max. motor shaft diameter	2	2	2	1.5	2	2	2	2
Order Number	118184	134777	134778		134780	118187	134783	134786
1 Reduction	5.4 : 1	24 : 1	104 : 1		455 : 1	850 : 1	1996 : 1	3728 : 1
2 Reduction absolute	27/5	1539/65	87723/845		5000211/10985	531441/625	285012027/142805	30292137/8125
3 Max. motor shaft diameter	1.5	2	2		2	1.5	2	2
Order Number		118185	134779		134781		134784	118188
1 Reduction		29 : 1	128 : 1		561 : 1		2458 : 1	4592 : 1
2 Reduction absolute		729/25	41553/325		2368521/4225		135005697/54925	14348907/3125
3 Max. motor shaft diameter		1.5	2		2		2	1.5
4 Number of stages	1	2	3	3	4	4	5	5
5 Max. continuous torque	0.10	0.15	0.20	0.20	0.25	0.25	0.30	0.30
6 Intermittently permissible torque at gear output	0.150	0.225	0.300	0.300	0.375	0.375	0.450	0.450
7 Max. efficiency	90	81	73	73	65	65	59	59
8 Weight	20	23	27	27	31	31	35	35
9 Average backlash no load	1.4	1.6	2.0	2.0	2.4	2.4	3.0	3.0
10 Mass inertia	0.07	0.05	0.05	0.04	0.05	0.05	0.05	0.05
11 Gearhead length L1	15.5	19.1	22.7	22.7	26.3	26.3	29.9	29.9



Combination

+ Motor	Page	+ Tacho / Brake	Page	Overall length [mm] = Motor length + gearhead length + (tacho / brake) + assembly parts							
RE 16, 2 W	72			37.9	41.5	45.1	45.1	48.7	48.7	52.3	52.3
RE 16, 2 W	72	MR	255/256	43.6	47.2	50.8	50.8	54.4	54.4	58.0	58.0
RE 16, 3.2 W	73/74			56.0	59.6	63.2	63.2	66.8	66.8	70.4	70.4
RE 16, 3.2 W	74	MR	255/256	61.0	64.6	68.2	68.2	71.8	71.8	75.4	75.4
RE 16, 3.2 W	74	MEnc 13	270	62.1	65.7	69.3	69.3	72.9	72.9	76.5	76.5
RE 16, 4.5 W	75/76			59.0	62.6	66.2	66.2	69.8	69.8	73.4	73.4
RE 16, 4.5 W	76	MR	255/256	64.0	67.6	71.2	71.2	74.8	74.8	78.4	78.4
RE 16, 4.5 W	76	MEnc 13	270	65.1	68.7	72.3	72.3	75.9	75.9	79.5	79.5
A-max 16	103-106			41.0	44.6	48.2	48.2	51.8	51.8	55.4	55.4
A-max 16	104/106	MR	255/256	46.0	49.6	53.2	53.2	56.8	56.8	60.4	60.4
A-max 16	104/106	MEnc 13	270	49.1	52.7	56.3	56.3	59.9	59.9	63.5	63.5
RE-max 17	133-136			41.0	44.6	48.2	48.2	51.8	51.8	55.4	55.4
RE-max 17	134/136	MR	255/256	46.0	49.6	53.2	53.2	56.8	56.8	60.4	60.4
EC 16, 15 W	156			55.8	59.4	63.0	63.0	66.6	66.6	70.2	70.2
EC 16, 15 W	156	MR	257	65.9	69.5	73.1	73.1	76.7	76.7	80.3	80.3
EC-max 16, 5 W	173			39.6	43.2	46.8	46.8	50.4	50.4	54.0	54.0
EC-max 16, 5 W	173	MR	257	46.9	50.5	54.1	54.1	57.7	57.7	61.3	61.3
EC-max 16, 2-wire	174			49.1	52.7	56.3	56.3	59.9	59.9	63.5	63.5

Option Ball Bearing

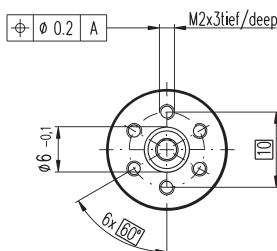

Order Number

4.4 : 1	138333	455 : 1	138343
5.4 : 1	138334	561 : 1	138344
19 : 1	138335	690 : 1	138345
24 : 1	138336	850 : 1	138346
29 : 1	138337	1621 : 1	138347
84 : 1	138338	1996 : 1	138348
104 : 1	138339	2458 : 1	138349
128 : 1	138340	3027 : 1	138350
157 : 1	138341	3728 : 1	138351
370 : 1	138342	4592 : 1	138352

Technical Data

Planetary Gearhead	straight teeth
Output shaft	stainless steel, hardened
Bearing at output	preloaded ball bearings
Radial play, 6 mm from flange	max. 0.08 mm
Axial play at axial load	< 4 N 0 mm
	> 4 N max. 0.05 mm
Max. permissible axial load	8 N
Max. permissible force for press fits	25 N
Sense of rotation, drive to output	=
Recommended input speed	< 8000 rpm
Recommended temperature range	-15 ... +100°C
Extended area as option	-35 ... +100°C
Number of stages	1 2 3 4 5
Max. radial load, 6 mm from flange	10 N 15 N 20 N 20 N 20 N
Gearhead values according to sleeve bearing version	