

Planetary Gearhead GP 16 K $\varnothing 16$ mm, 0.06 - 0.18 Nm

Plastic Version

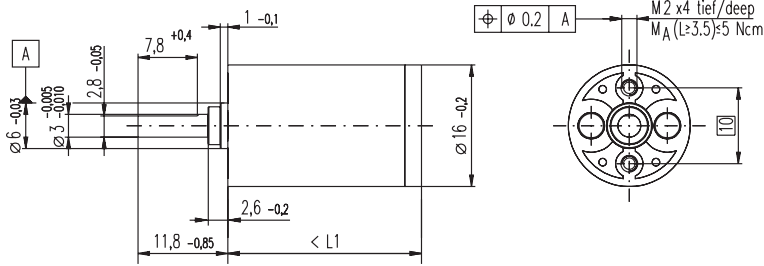

M 1:1

Technical Data

Planetary Gearhead	straight teeth
Housing, planetary wheels	plastic
Output shaft	stainless steel, hardened
Bearing at output	sleeve bearing
Radial play, 6 mm from flange	max. 0.14 mm
Axial play	0.02 - 0.10 mm
Max. permissible axial load	5 N
Max. permissible force for press fits	100 N
Sense of rotation, drive to output	=
Recommended input speed	< 8000 rpm
Recommended temperature range	-15 ... +80°C
Extended area as option	-35 ... +80°C
Number of stages	1 2 3 4 5
Max. radial load, 6 mm from flange	2 N 3 N 4 N 5 N 5 N

- Stock program
- Standard program
- Special program (on request)

Order Number

	112862	112863	112864	112865	112866
Gearhead Data					
1 Reduction	4.4 : 1	19 : 1	84 : 1	370 : 1	1621 : 1
2 Reduction absolute	$\frac{57}{13}$	$\frac{3249}{169}$	$\frac{185193}{2197}$	$\frac{10556001}{28561}$	$\frac{601692057}{371293}$
3 Max. motor shaft diameter mm	2	2	2	2	2
4 Number of stages	1	2	3	4	5
5 Max. continuous torque Nm	0.06	0.09	0.12	0.15	0.18
6 Intermittently permissible torque at gear output Nm	0.06	0.09	0.12	0.15	0.18
7 Max. efficiency %	85	70	60	50	45
8 Weight g	6.4	7.7	8.4	9.1	9.8
9 Average backlash no load °	1.8	2.0	2.2	2.5	2.8
10 Mass inertia gcm ²	0.06	0.03	0.03	0.03	0.03
11 Gearhead length L1* mm	16.5	22.0	25.5	29.0	32.5

* for RE 15 and RE 16 is L1 - 1.0 mm

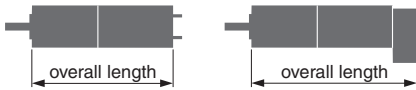

Combination

+ Motor	Page	+ Tacho / Brake	Page	Overall length [mm] = Motor length + gearhead length + (tacho / brake) + assembly parts				
RE 16, 2 W	72			37.9	43.4	46.9	50.4	53.9
RE 16, 2 W	72	MR	255/256	43.6	49.1	52.6	56.1	59.6
RE 16, 3.2 W	73/74			56.0	61.5	65.0	68.5	72.0
RE 16, 3.2 W	74	MR	255/256	61.0	66.5	70.0	73.5	77.0
RE 16, 3.2 W	74	MEnc 13	270	62.1	67.6	71.1	74.6	78.1
RE 16, 4.5 W	75/76			59.0	64.5	68.0	71.5	75.0
RE 16, 4.5 W	76	MR	255/256	64.0	69.5	73.0	76.5	80.0
RE 16, 4.5 W	76	MEnc 13	270	65.1	70.6	74.1	77.6	81.1
A-max 16	103-106			42.0	47.5	51.0	54.5	58.0
A-max 16	104/106	MR	255/256	47.0	52.5	56.0	59.5	63.0
A-max 16	104/106	MEnc 13	270	50.1	55.6	59.1	62.6	66.1
RE-max 17	133-136			42.0	47.5	51.0	54.5	58.0
RE-max 17	134/136	MR	255/256	47.0	52.5	56.0	59.5	63.0