

A 2520 Ø20 mm, Precious Metal Brushes, 1.2 Watt

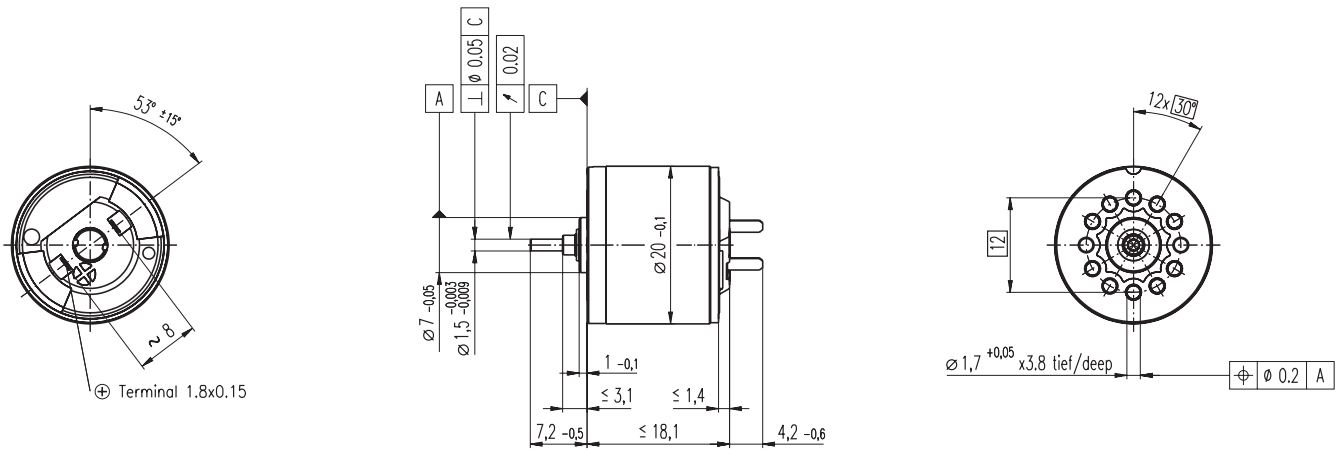

M 1:1

- Stock program
- Standard program
- Special program (on request)

Order Number

2520. ... -11.111-000 (Insert winding number)

Winding number

854	852	853
-----	-----	-----

Motor Data

Values at nominal voltage		854	852	853	
1	Nominal voltage	V	6.0	9.0	12.0
2	No load speed	rpm	13600	13400	13000
3	No load current	mA	18.5	12.2	8.73
4	Nominal speed	rpm	6400	5730	4090
5	Nominal torque (max. continuous torque)	mNm	1.07	0.998	0.858
6	Nominal current (max. continuous current)	A	0.275	0.169	0.107
7	Stall torque	mNm	2.05	1.76	1.27
8	Starting current	A	0.504	0.287	0.152
9	Max. efficiency	%	67	65	60
Characteristics					
10	Terminal resistance	Ω	11.9	31.4	78.7
11	Terminal inductance	mH	0.209	0.475	0.875
12	Torque constant	mNm / A	4.07	6.14	8.33
13	Speed constant	rpm / V	2350	1560	1150
14	Speed / torque gradient	rpm / mNm	6870	7950	10800
15	Mechanical time constant	ms	59.7	61.2	65.8
16	Rotor inertia	gcm ²	0.830	0.735	0.580

Specifications

Thermal data		
17	Thermal resistance housing-ambient	25.5 K / W
18	Thermal resistance winding-housing	28.2 K / W
19	Thermal time constant winding	9.65 s
20	Thermal time constant motor	255 s
21	Ambient temperature	-20 ... +65°C
22	Max. permissible winding temperature	+85°C
Mechanical data (sleeve bearings)		
23	Max. permissible speed	14700 rpm
24	Axial play	0.05 - 0.15 mm
25	Radial play	0.012 mm
26	Max. axial load (dynamic)	0.5 N
27	Max. force for press fits (static)	40 N
28	Max. radial loading, 5 mm from flange	1.4 N

Other specifications

29	Number of pole pairs	1
30	Number of commutator segments	5
31	Weight of motor	20 g

Values listed in the table are nominal.
Explanation of the figures on page 49.

Operating Range

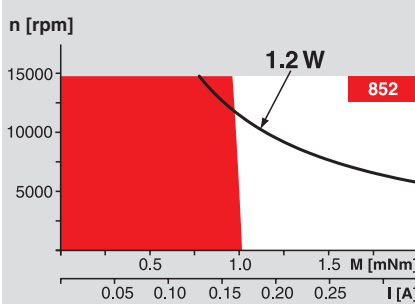

Comments

- Continuous operation**
In observation of above listed thermal resistance (lines 17 and 18) the maximum permissible winding temperature will be reached during continuous operation at 25°C ambient.
= Thermal limit.
- Short term operation**
The motor may be briefly overloaded (recurring).
- Assigned power rating**

maxon Modular System

Overview on page 16 - 21

