

A 2515 $\varnothing 15$ mm, Precious Metal Brushes, 2 Watt, C€ approved

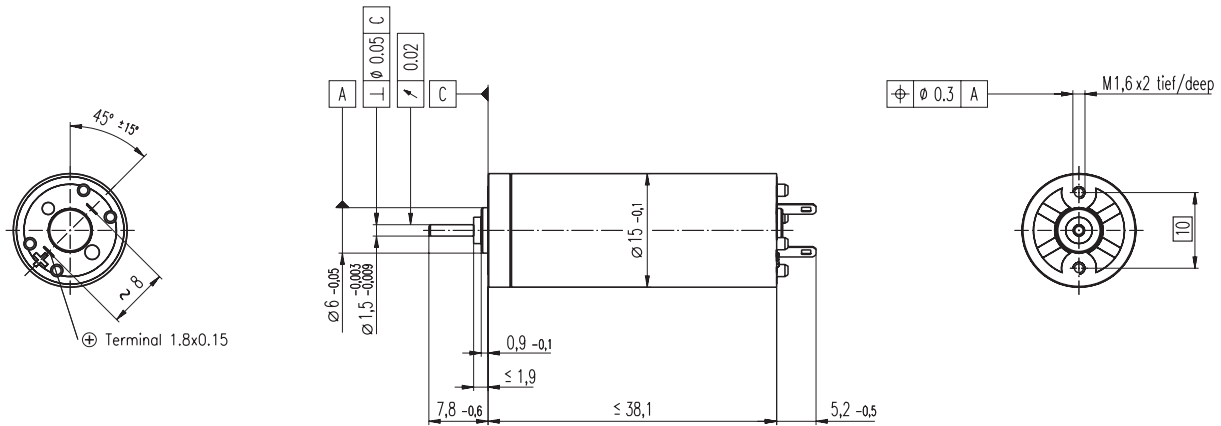

M 1:1

- Stock program
- Standard program
- Special program (on request)

Order Number

2515. ... -11.111-000 (Insert winding number)

Winding number

980	981	984	985	986	987	988	989	990	992	994
-----	-----	-----	-----	-----	-----	-----	-----	-----	-----	-----

Motor Data

Values at nominal voltage		980	981	984	985	986	987	988	989	990	992	994	
1	Nominal voltage	Volt	1.2	1.2	3.0	3.6	4.5	6.0	7.2	9.0	12.0	18.0	24.0
2	No load speed	rpm	6010	5600	8070	7750	7740	8070	7740	8060	8600	8500	7180
3	No load current	mA	47.0	42.4	29.7	23.2	18.6	14.8	11.6	9.89	8.22	5.38	3.1
4	Nominal speed	rpm	4690	3970	5040	4040	4030	4330	4000	4260	4810	4650	3270
5	Nominal torque (max. continuous torque)	mNm	1.27	1.37	2.44	3.05	3.05	3.02	3.02	2.96	2.95	2.91	2.90
6	Nominal current (max. continuous current)	A	0.720	0.720	0.720	0.716	0.571	0.443	0.354	0.29	0.231	0.151	0.0946
7	Stall torque	mNm	5.83	4.77	6.54	6.43	6.40	6.57	6.30	6.33	6.74	6.48	5.36
8	Starting current	A	3.11	2.37	1.87	1.47	1.17	0.939	0.721	0.604	0.514	0.326	0.171
9	Max. efficiency	%	77	76	77	77	77	77	77	77	77	77	76
Characteristics			980	981	984	985	986	987	988	989	990	992	994
10	Terminal resistance	Ω	0.386	0.505	1.60	2.45	3.84	6.39	9.99	14.9	23.3	55.2	140
11	Terminal inductance	mH	0.0304	0.0348	0.105	0.164	0.257	0.421	0.657	0.947	1.48	3.4	8.46
12	Torque constant	mNm / A	1.88	2.01	3.49	4.37	5.46	6.99	8.74	10.5	13.1	19.9	31.3
13	Speed constant	rpm / V	5080	4750	2730	2190	1750	1370	1090	911	729	480	305
14	Speed / torque gradient	rpm / mNm	1050	1200	1250	1220	1230	1250	1250	1290	1300	1330	1360
15	Mechanical time constant	ms	18.6	18.1	17.0	16.8	16.8	16.8	16.7	16.8	16.8	16.9	16.9
16	Rotor inertia	gcm ²	1.70	1.44	1.30	1.31	1.30	1.28	1.28	1.24	1.24	1.21	1.18

Specifications

Thermal data		
17	Thermal resistance housing-ambient	30 K / W
18	Thermal resistance winding-housing	8.5 K / W
19	Thermal time constant winding	10 s
20	Thermal time constant motor	n.i.
21	Ambient temperature	-20 ... +65°C
22	Max. permissible winding temperature	+85°C
Mechanical data (sleeve bearing)		
23	Max permissible speed	9500 rpm
24	Axial play	0.1 - 0.2 mm
25	Radial play	0.012 mm
26	Max. axial load (dynamic)	0.45 N
27	Max. force for press fits (static)	40 N
28	Max. radial loading, 5 mm from flange	1.5 N

Other specifications

29	Number of pole pairs	1
30	Number of commutator segments	5
31	Weight of motor	30 g

Values listed in the table are nominal.
Explanation of the figures on page 49.

Option

Pigtails in place of terminals

Operating Range

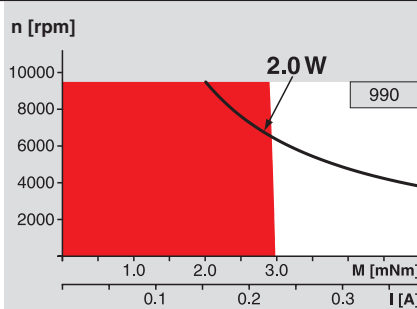

Comments

- Continuous operation**
In observation of above listed thermal resistance (lines 17 and 18) the maximum permissible winding temperature will be reached during continuous operation at 25°C ambient.
= Thermal limit.
- Short term operation**
The motor may be briefly overloaded (recurring).
- Assigned power rating**

maxon Modular System

Overview on page 16 - 21

- Planetary Gearhead**
 $\varnothing 16$ mm
0.01 - 0.03 Nm
Page 219
- Planetary Gearhead**
 $\varnothing 16$ mm
0.06 - 0.18 Nm
Page 223
- Spur Gearhead**
 $\varnothing 24$ mm
0.1 Nm
Page 234

