

EC 22 Ø22 mm, brushless, 20 Watt, with integrated electronics

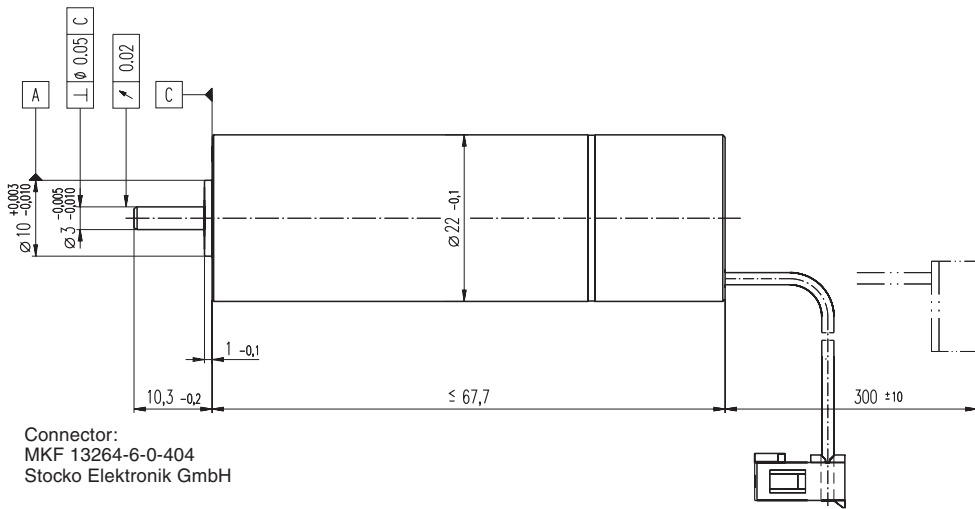

Connector:
MKF 13264-6-0-404
Stocko Elektronik GmbH

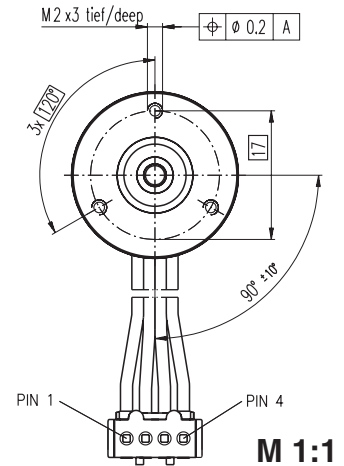

M 1:1

- Stock program
- Standard program
- Special program (on request)

Order Number

201164	200293
--------	--------

Motor Data

		201164	200293
Values at nominal voltage			
1	Nominal voltage	V	24.0
2	No load speed	rpm	28900
3	No load current	mA	264
4	Nominal speed	rpm	27800
5	Nominal torque (max. continuous torque)	mNm	8.98
6	Nominal current (max. continuous current)	A	1.39
7	Stall torque	mNm	19.6
8	Starting current	A	2.50
9	Max. efficiency	%	83
Characteristics			
10	Terminal resistance phase to phase	Ω	n.i.
11	Terminal inductance phase to phase	mH	n.i.
12	Torque constant	mNm / A	7.85
13	Speed constant	rpm / V	1220
14	Speed / torque gradient	rpm / mNm	118
15	Mechanical time constant	ms	5.20
16	Rotor inertia	gcm ²	4.20

Specifications

Thermal data	
17	Thermal resistance housing-ambient
18	Thermal resistance winding-housing
19	Thermal time constant winding
20	Thermal time constant motor
21	Ambient temperature
22	Max. permissible winding temperature
Mechanical data (preloaded ball bearings)	
23	Max. permissible speed
24	Axial play at axial load < 5 N
25	Radial play
26	Max. axial load (dynamic)
27	Max. force for press fits (static)
28	Max. radial loading, 5 mm from flange
Other specifications	
29	Number of pole pairs
30	Number of phases
31	Weight of motor

Values listed in the table are nominal.

Caution

Wrong polarity will destroy the electronics

- ⚠ **Caution:** the direction of rotation (DIR) may only be changed when the motor is at standstill, otherwise the electronics can be damaged.

Connection

green	+V _{CC} 10 ... 50 VDC	Pin 1
blue	GND	Pin 2
violet	Disable	Pin 3
grey	Direction	Pin 4

Operating Range

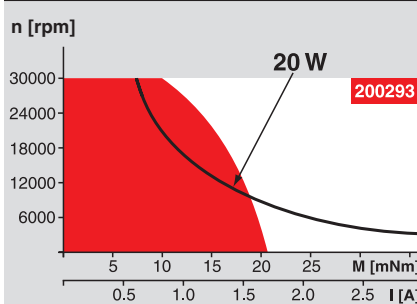

Comments

Continuous operation
In observation of above listed thermal resistance (lines 17 and 18) the maximum permissible winding temperature will be reached during continuous operation at 25°C ambient.
= Thermal limit.

Short term operation
The motor may be briefly overloaded (recurring).

— **Assigned power rating**

maxon Modular System

Overview on page 16 - 21

Planetary Gearhead
Ø22 mm
0.5 - 2.0 Nm
Page 232

